

Objective

Ascolino made of 5052 aluminium and covered in resistant optical lens with, the item is solid, tough and durable: its life is 5 time more of the metal-halide (MH) lights. This item make the choice to switch to LED technology very easy, and the very simple installation with low maintenance is a plus. The high efficiency of the LED system here mounted provides high lumen performances and considerable energy saving. This product is ideal for facade application and wall grazing requirements plus the features of many beam angle options.

Obiettivo

Ascolino realizzato in alluminio 5052 e ricoperto da una lente ottica resistente, l'oggetto è solido, resistente e durevole: la sua durata è 5 volte maggiore delle luci ad alogenuri metallici (MH). Questo articolo rende la scelta di passare alla tecnologia LED molto semplice e l'installazione molto semplice con poca manutenzione è un vantaggio. L'elevata efficienza del sistema LED qui montato offre elevate prestazioni di lumen e un notevole risparmio energetico. Questo prodotto è ideale per l'applicazione di facciate e le esigenze di pascolo delle pareti oltre alle caratteristiche di molte opzioni di angolo del fascio.

Description

Housing - Resist corrosion proof 5052 aluminum, extruded alum heat sink plates along with mounting bracket and option of RAL color powder coating.

Diffuser - Optical lens fitted over silicon rubber gasket.

LED - reducing energy consumption with L80/B10/F10 50,000 hrs lifetime.

Standards - manufactured in accordance with tested as per PTPS IEC 62722.

Accessories - Options of adjustable stainless steel bracket for surface installation. Honeycomb louver, cowl.

CODE	WATTAGE	LUMEN	SIZE mm
2153008	8W	1040lm	300 X 40 X 23H
2153017	17W	2210lm	600 X 40 X 23H
2153026	26W	3380lm	1000 X 40 X 23H
2153034	34W	4420lm	1200 X 40 X 23H

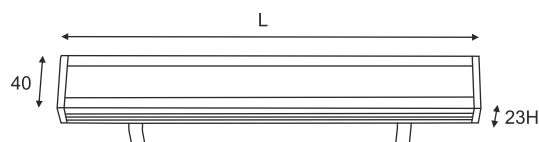
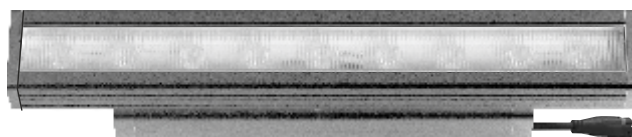

LED	Energy Star	ECO	RoHS
PHASE DIMMING	DALI	1-10 DIMMING	Different length
65°C	Glowing Wire	-20°C	Test - 850°
IP 65	IK 09	UGR <21	SDCM 2.0/3.0
CIDET	EAC	COMPLIANCE LM-79 TM-21	LM-80
PASEL ACCREDITATION	SMD	CRI >90	series wiring
ROHS	SELV	F	series wiring
CE	COMPLIANCE	U	
A++	DC 24V	220~240V	50/60Hz

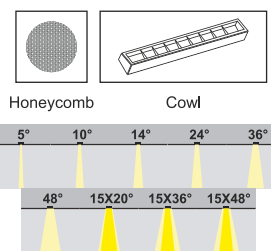
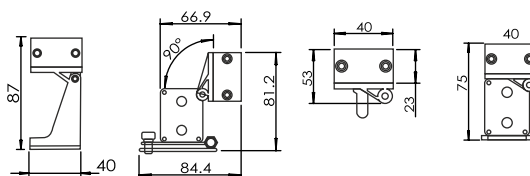
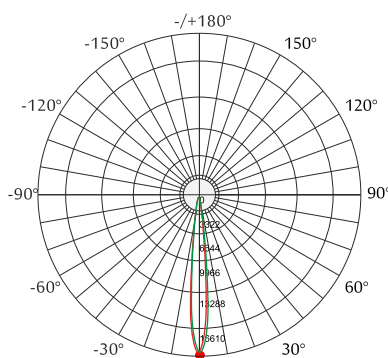

2700K
3000K
4000K
5000K
6000K
6500K



LED Drivers - PHILIPS GTI, MEAN WELL, GTCI TRIDONIC, LED Chips - BRIDGELUX, CREE, SHARP, SAMSUNG, PHILIPS, CITIZEN

In a continuing effort to offer the best product possible, we reserve the right to change, without notice, specifications or materials that in our opinion will not alter the function of the product. Specification sheets found at www.romaluce.it are the most recent versions and supercede all other printed or electronic versions.