

Objective

Shielded LED bollard with wide beam light distribution for a high degree of illuminance on the ground surface. A reflector directs the light directly onto the surface to be illuminated. Robust and striking luminaires that can divide up and structure outdoor spaces. They have an orienting, guiding and demarcating function. For the illumination of squares entrance or rectangular it's a perfect choice.

Obiettivo

Dissuasore a LED schermato con distribuzione della luce a fascio largo per un elevato grado di illuminamento della superficie del terreno. Un riflettore dirige la luce direttamente sulla superficie da illuminare. Apparecchi di illuminazione robusti e sorprendenti che possono dividere e strutturare gli spazi esterni. Hanno una funzione di orientamento, guida e delimitazione. Per l'illuminazione di quadrati o ingressi rettangolari è una scelta perfetta.

Description

- Housing** - High purity aluminium powder coated with choice of RAL colors
 - Diffuser** - Tempered clear glass with optical glass lens.
 - LED** - reducing energy consumption with L80/B10/F10 50,000 hrs lifetime.
 - Standards** - manufactured in accordance with tested as per PTPS IEC 62722
- Bollard light is subject to adjust upon request.
- Accessories** - Surface Mounting plate.

CODE	WATTAGE	LUMEN	SIZE mm
1330308	8W	880lm	150 X 150 X 800H
1330315	15W	1650lm	150 X 150 X 800H
1330320	20W	2200lm	150 X 150 X 800H



LED			
PHASE DIMMING	DALI	1-10 DIMMING	ENERGY STAR
65°C	Glowing Wire Test - 850°		
-20°C	IP 65	IK 08	UGR <22
COMPLIANCE		SDCM 2.0/3.0	
CIDET	EAC	LM-79 TM-21 (LM-80)	
PASEL ACCREDITATION	COB	CRI >90	
ROHS	SELV	F	ECO
CE	COMPLIANCE	RECYCLE	U
A++		220~265V 50/60Hz	

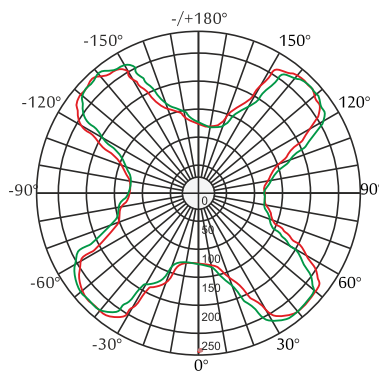

Mounting plate

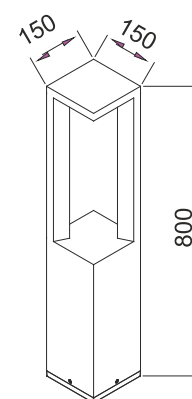
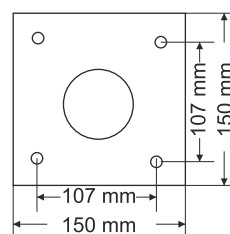

- 2700K
- 3000K
- 4000K
- 5000K
- 6000K
- 6500K

